

THE WILLOW - 4 BEDROOM HOUSE - SEMI DETACHED

ROOM DIMENSIONS

THE WILLOW - 4 BED

LOUNGE	2.89m x 5.21m	9'5" x 17'1"
KITCHEN/DINING	5.32m x 3.00m	17'5" x 9'10"
CLOAKS	1.02m x 2.04m	3'4" x 6'8"

* MAXIMUM ROOM DIMENSIONS

ROOM DIMENSIONS

THE WILLOW - 4 BED

BEDROOM 1	3.02m* x 3.74m*	9'11"* x 12'3"*
BEDROOM 2	3.22m* x 3.03m*	10'7"* x 9'11"*
BEDROOM 3	2.03m x 3.03m	6'7" x 9'11"
BEDROOM 4	2.25m* x 3.74m*	7'4"* x 12'3"*
BATHROOM	2.00m x 2.00m	6'6" x 6'6"

* MAXIMUM ROOM DIMENSIONS

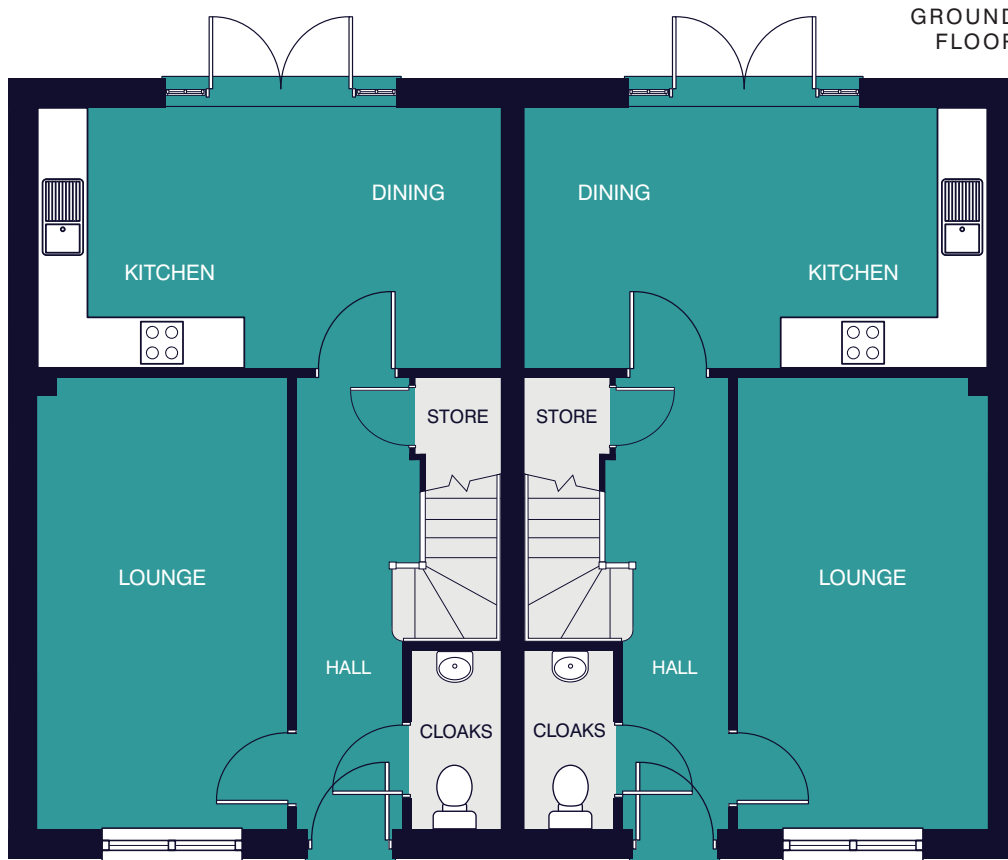

PLOT 39

PLOT 38

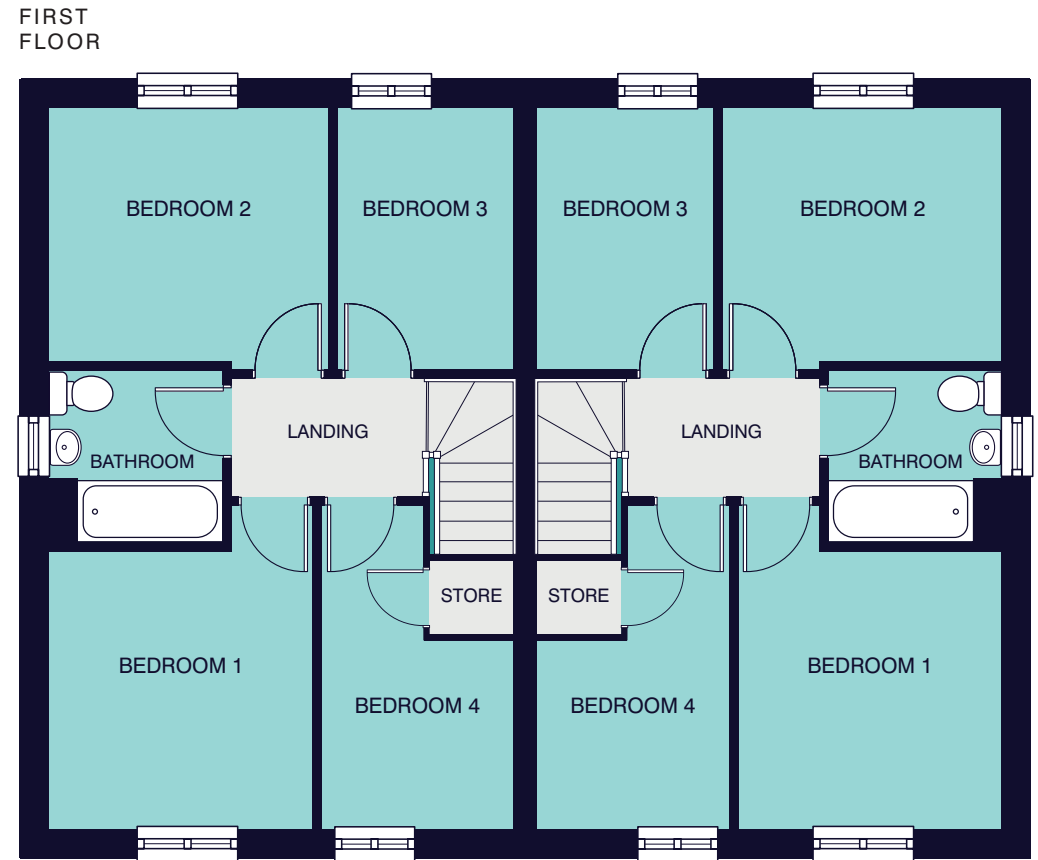

PLOT 39

PLOT 38